

# ADVENTURES WITH



 **pace**  
BUS  
ONLY

 **Illinois**  
Tollway



## SmartRoad

Travel safe • Travel **smart**



## HI, I'M JANE!

MY NEIGHBORS SIRI, WATSON AND ALEXA THINK THEY ARE SO SMART - UMMM, NOT! A VIRTUAL ASSISTANT SHOULD NEVER RESPOND WITH "I DON'T UNDERSTAND THE QUESTION" - REALLY?!

PERSONALLY I LOVE ANSWERING QUESTIONS ABOUT THE TOLLWAY'S NEW SMARTROAD ON I-90. I CANNOT STOP BRAGGING ABOUT ITS TECHNOLOGY - AS I ALWAYS SAY, "YOUR SMART PHONE IS NO MATCH FOR SMARTROAD'S HIGH-TECH COMMUNICATION SKILLS."

NOW, GRAB YOUR BEVERAGE AND PUT YOUR FEET UP - I'M GOING TO TAKE YOU ON YOUR FIRST ADVENTURE ON THE NEW SMARTROAD! AS YOU WILL SEE, MY FRIENDS ARE STUCK IN A 1950'S TIME WARP AND ARE EASILY CONFUSED BY MODERN TECHNOLOGY. LET'S SEE IF WE CAN GET THEM INTO THE 21ST CENTURY!

 pace  
BUS  
ONLY

 Illinois  
Tollway

FOR MORE INFORMATION, VISIT [ILLINOISTOLLWAY.COM](http://ILLINOISTOLLWAY.COM)

# SMARTROAD



OH SKIP, THOSE ARE CALLED "GANTRIES." THEY COLLECT DATA AND SHARE INFO WITH DRIVERS LIKE YOU.

IT'S THE LATEST RAGE FOR TRANSPORTATION NERDS LIKE ME.

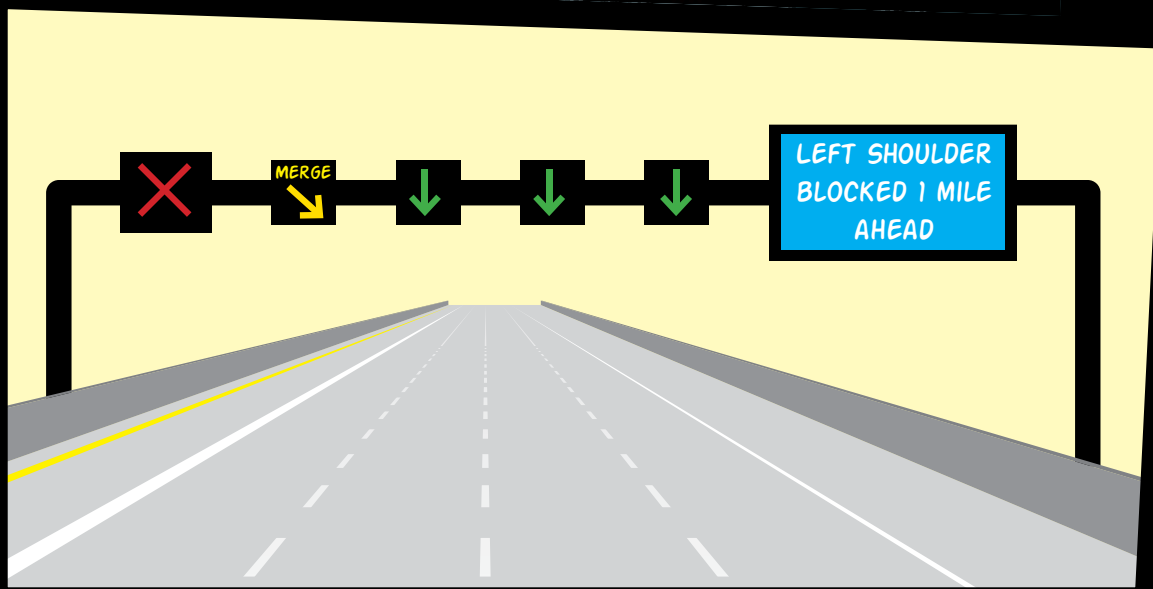

# BLANK SIGNS



MARIA, THE SIGNS ARE BLANK WHEN THERE ARE NO INCIDENTS TO REPORT ON THE ROAD.

PERSONALLY, I RECOMMEND DOUBLE-SHOT ESPRESSO TO KEEP YOU ALERT ON AND OFF THE ROAD - BUT THAT'S JUST ME!

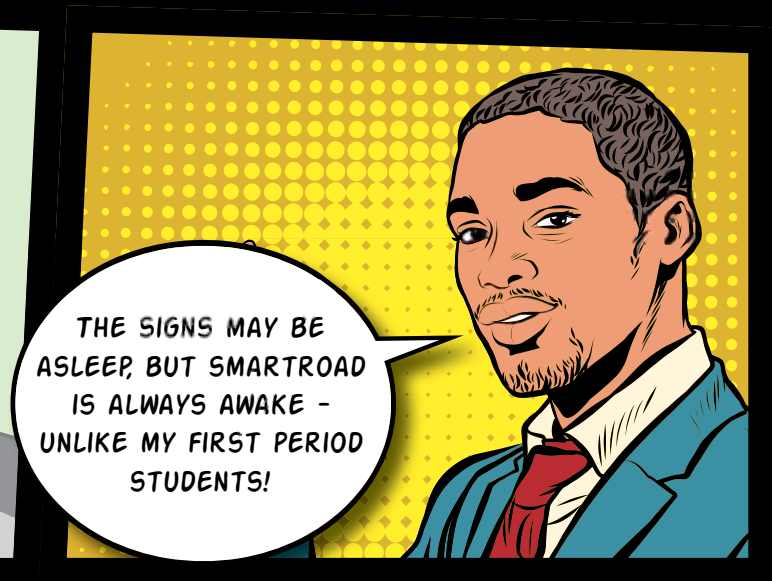
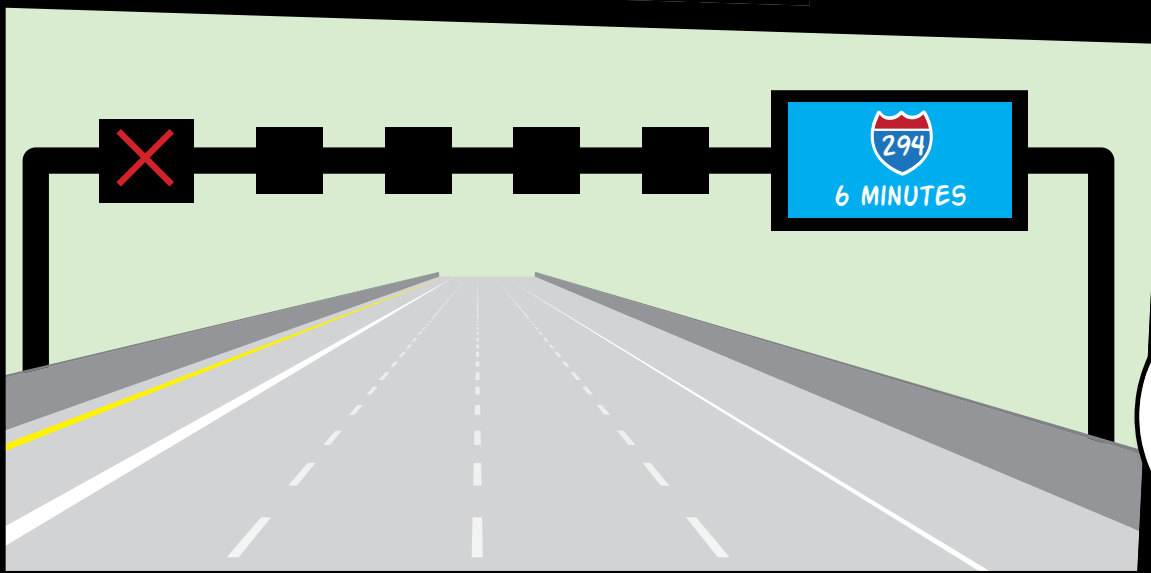

# X'S AND ARROWS

OF COURSE THE  
COLORS CORRESPOND TO  
TRAFFIC SIGNALS...  
THIS IS A  
SMART ROAD!

JANE, DID A  
SPACESHIP LAND? WHY  
ARE THERE SO MANY  
COLORFUL LIGHTS  
AHEAD?

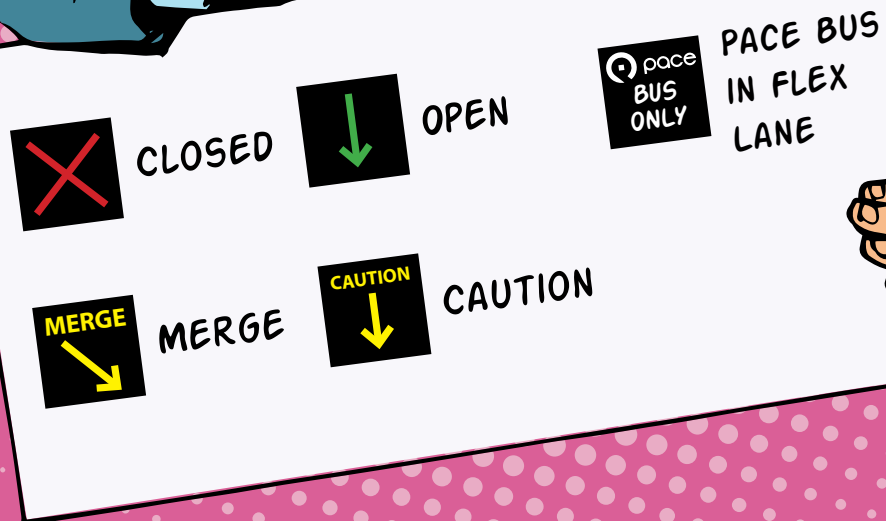

DON'T GO APE, BIF! THE COLORFUL  
LIGHTS ARE SMARTROAD SIGNS.  
WHILE I NEITHER CONFIRM NOR DENY  
THE EXISTENCE OF SPACESHIPS,  
I SUGGEST YOU LEARN TO SPEAK  
SMARTROAD BEFORE  
STUDYING MARTIAN!



# PACE BUS



JANE, IS THAT  
PACE BUS CRUISIN'  
FOR A BRUISIN' OR  
DID IT JUST PASS  
EVERYONE ON THE  
SHOULDER?

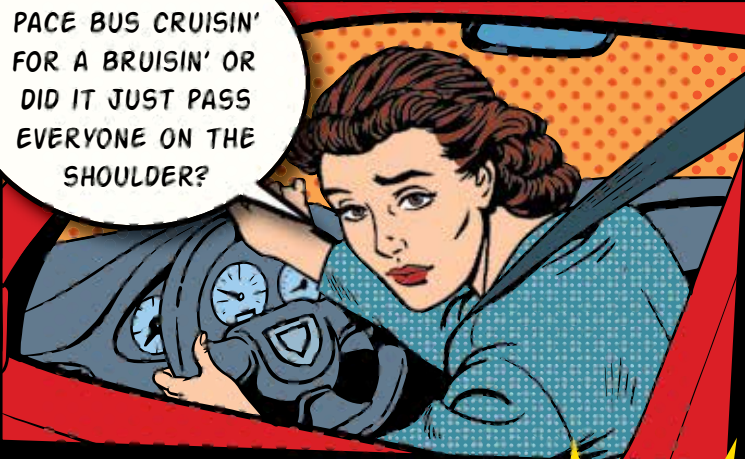

DON'T GET FROSTED, BUNNY!  
PACE BUSES ARE ALLOWED TO PASS  
ON THE SHOULDER (AKA FLEX LANE)  
WHEN THE "PACE BUS ONLY" SIGN IS ON.

I SHOULD BE THRILLED  
THAT THE PACE EXPRESS  
BUS ON I-90 GETS ME TO  
WORK ON TIME - ONLY NOW I  
DON'T HAVE AN EXCUSE TO BE  
LATE FOR BOGUS MEETINGS!



# FLEX LANE



BETTY,  
YOU CAN'T PULL  
OVER HERE!

GET WITH  
IT, MARTY! JANE  
SAYS I CAN ALWAYS  
USE THE FLEX LANE FOR  
EMERGENCIES, EVEN IF THE  
"PACE BUS ONLY" SIGN  
IS ON.

BETTY IS RIGHT (AS USUAL)  
YOU OLD GOOF! NOT ONLY DO  
PACE BUS DRIVERS HAVE GREAT  
EYESIGHT, SMARTROAD WILL  
NOTIFY DRIVERS OF AN INCIDENT  
AHEAD OF TIME.

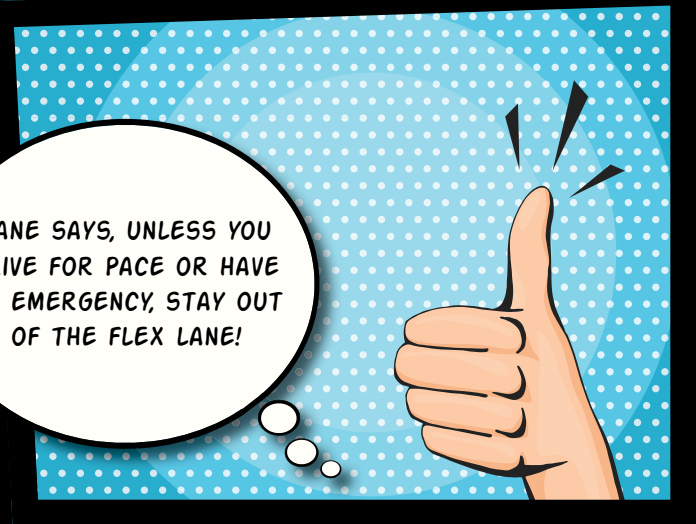
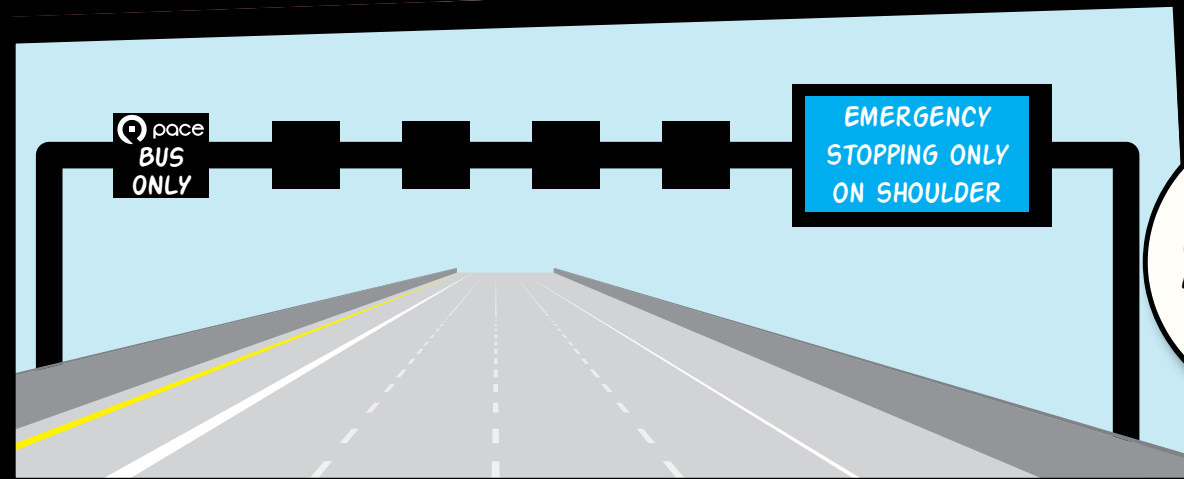

JANE SAYS, UNLESS YOU  
DRIVE FOR PACE OR HAVE  
AN EMERGENCY, STAY OUT  
OF THE FLEX LANE!

# SAFETY



H.E.L.P.  
TRUCK  
NEEDED AT  
MILEPOST 6  
STAT!



IGNORE MARTY'S  
CRYING AND ICE THAT AUTO  
REPAIR MANUAL, BETTY.

SMARTROAD CAN DETECT  
MOST BREAKDOWNS SO A  
H.E.L.P. TRUCK HAS ALREADY  
BEEN DISPATCHED!

DIALING \*999 IS  
ANOTHER QUICK AND  
EASY WAY TO GET  
H.E.L.P. ALONG THE  
TOLLWAY. I WAS  
EVEN ABLE TO USE  
THE H.E.L.P. TRUCK  
TRACKER TO SEE  
WHEN THE TRUCK WAS  
GETTING CLOSE!



THIS IS JANE SIGNING OFF  
WITH A KEEN "LATER GATOR!"





# PLAY THE JANE GAME!

JANE WISHES YOU A SAFE AND HAPPY JOURNEY ALONG I-90, BUT FIRST SHE WANTS TO SEE IF YOU CAN PASS HER SMARTROAD POP QUIZ! ARE YOU UP FOR THE CHALLENGE!?

- 1) WHY ARE THE SIGNS BLANK?
  - A) LOST POWER
  - B) NOTHING TO REPORT
  - C) OPERATORS ARE ON VACATION
  
- 2) WHO CAN USE THE INSIDE SHOULDER WHEN THE "PACE BUS ONLY" SIGN IS ON?
  - A) PACE BUSES
  - B) ANYONE WHO IS RUNNING LATE
  - C) BROKEN DOWN VEHICLES
  - D) BOTH A AND C
  
- 3) TRUE OR FALSE: THE GANTRIES INSTALLED EVERY HALF-MILE COLLECT TOLLS.
  - A) TRUE
  - B) FALSE

ANSWERS: 1) B, 2) D, 3) B - THANKS FOR PLAYING!

