



Signage and Markings Guidelines

Bridget Malinowski

March 2013

Signage and Marking Guidelines



Signage and Markings Guidelines 2012 Edition



Signage and Marking Guidelines

Manual on Uniform Traffic Control Devices

2009 EDITION

Illinois Supplement to the
National Manual on Uniform
Traffic Control Devices



Illinois Department of Transportation
Division of Highways

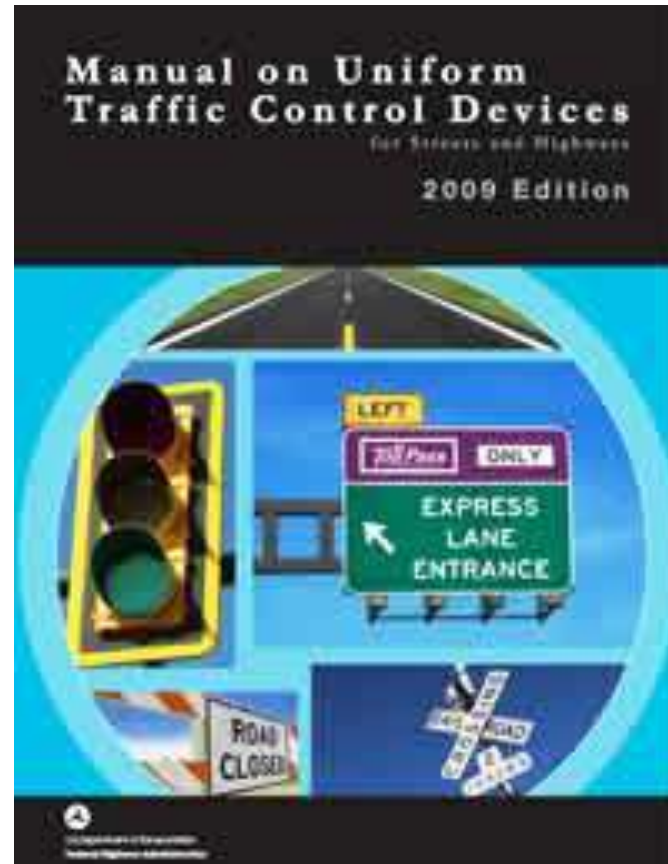

Chapter 1 - Sign Guidelines

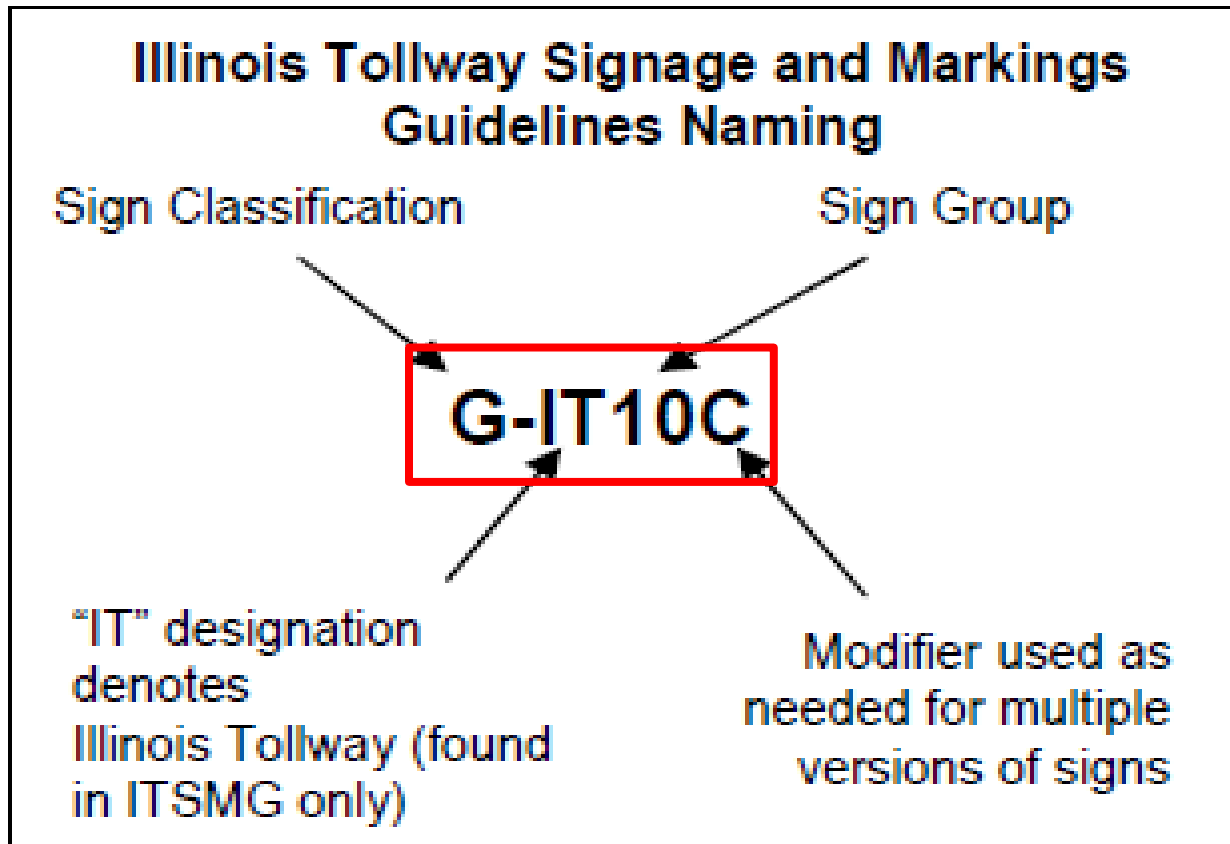
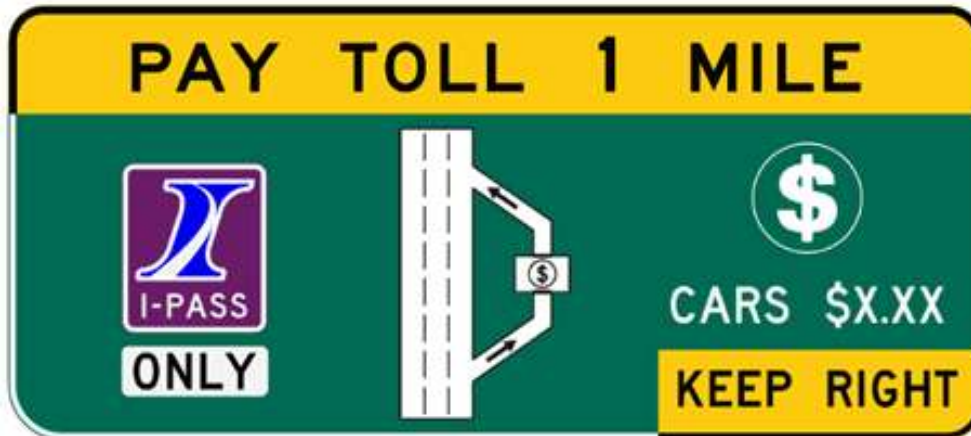

Figure 1-1 Sign Naming Conventions



Chapter 2 – Sign Specifications



Chapter 3 Sign Placement

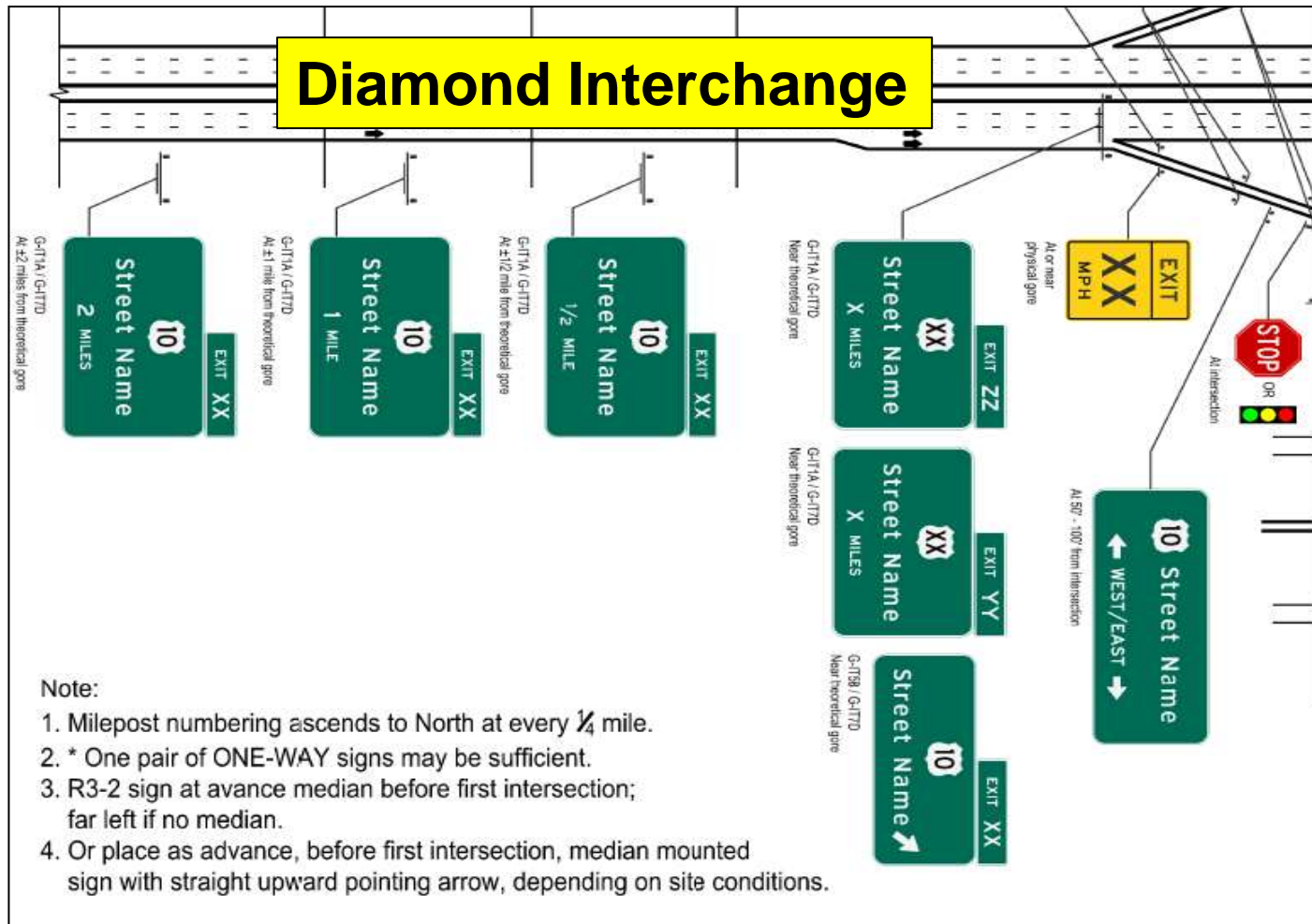

Chapter 3 Sign Placement

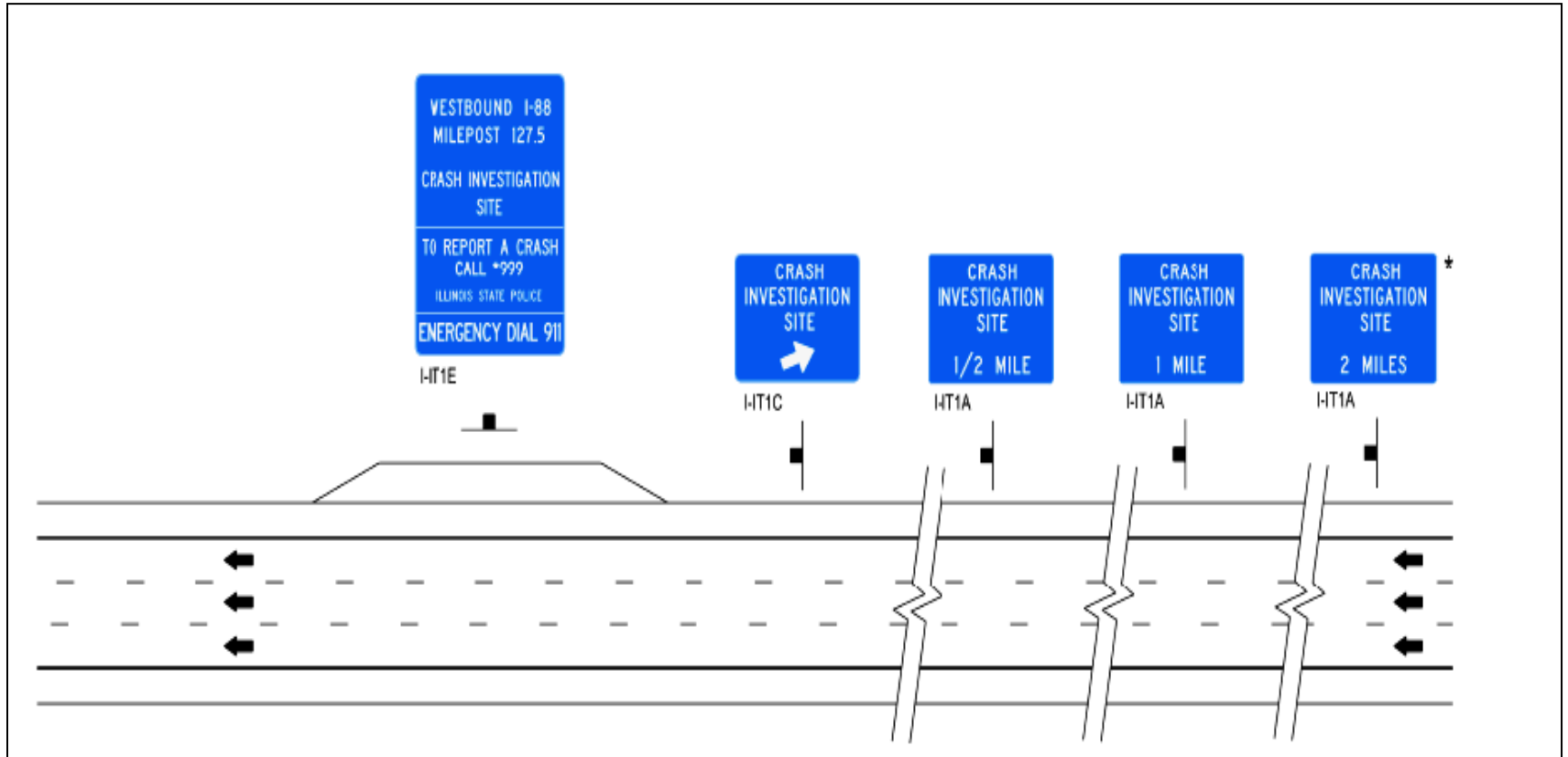

Crash Investigation Site (CIS) Sign Placement Illustration

Chapter 3 Sign Placement

Mainline Plaza with Interchange Exit and IPO Lanes

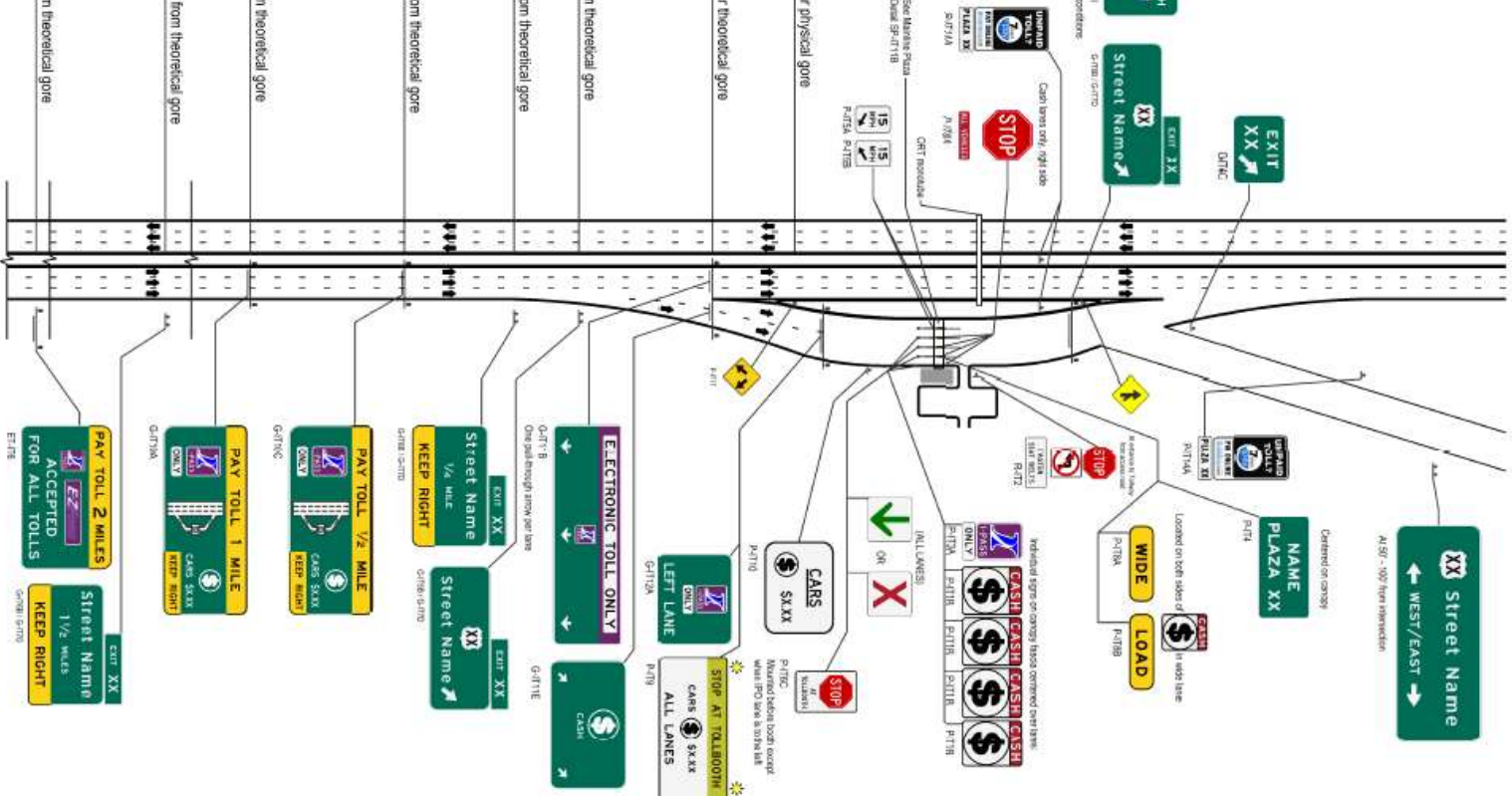

Chapter 4 Guide Signs

GUIDE SIGN ILLUSTRATION
Advance Exit: Shield, 2 Street Names, X Miles

[Not to scale]



Dimensions are inches tenths.
 Letter locations are panel edge to lower left corner.

NOTE:
 SIGN WIDTH WILL VARY BASED ON SIZE ON STREET NAMES

SIGN NUMBER	G-ITIE
MUTCD CITATION	2E.33
WIDTH x HIGHT	15'-0" x 13'-0"
BORDER WIDTH	2"
CORNER RADIUS	12"
MOUNTING	Overhead
BACKGROUND	TYPE: Reflective
	COLOR: Green
LEGEND/BORDER	TYPE: Reflective
	COLOR: White /White

SYMBOL	ROT	X	Y	WID	HT
M1-1100A	0	69.7	99.8	40.5	36

LETTER POSITIONS (X)										LENGTH	SERIES/SIZE	
C	I	C	E	R	O		A	V	E			ClearviewHwy-5-W
18.1	35.6	44.4	59.3	75.5	87.9	100.2	136.9	134.5	150.2		144	16/13
1	2	7	1									ClearviewHwy-5-W
33.8	46.2	61.3	75								106.4	16/13
2	M	I	L									E 2000
55.1	82.3	94.3	98.7	107.9	116.8						89.8	15,10

Advanced Exit Sign



Chapter 4 Guide Signs

GUIDE SIGN ILLUSTRATION Exit Gore: Exit, Single Digit Exit Number and Letter, Directional Arrow

[Not to scale]

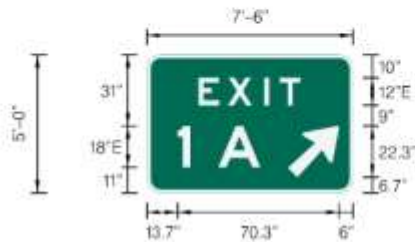

Dimensions are inches tenths
Letter locations are panel edge to lower left corner

SIGN NUMBER	G-IT4B
MUTCD CITATION	2E 37
WIDTH x HGT.	7'-6" x 5'-0"
BORDER WIDTH	1.5"
CORNER RADIUS	6"
MOUNTING	Ground
BACKGROUND	TYPE: Reflective
	COLOR: Green
LEGEND/BORDER	TYPE: Reflective
	COLOR: White /White

SYMBOL	ROT	X	Y	WID	HT
AR_Type A	315	61.7	6.7	18	28.4

LETTER POSITIONS (X)										LENGTH	SERIES SIZE	
E	X	I	T								E 2000	
22.8	35.6	51.4	58.2								44.4	12
1	A										E 2000	
13.7	31.4										36	18

Exit Gore Sign



Chapter 4 Guide Signs

Trailblazer Assembly Signs



G-IT24A



G-IT24B



G-IT24C

Chapter 5 Regulatory Signs



Chapter 6 Warning Signs



W1-13



W1-8



W13-3

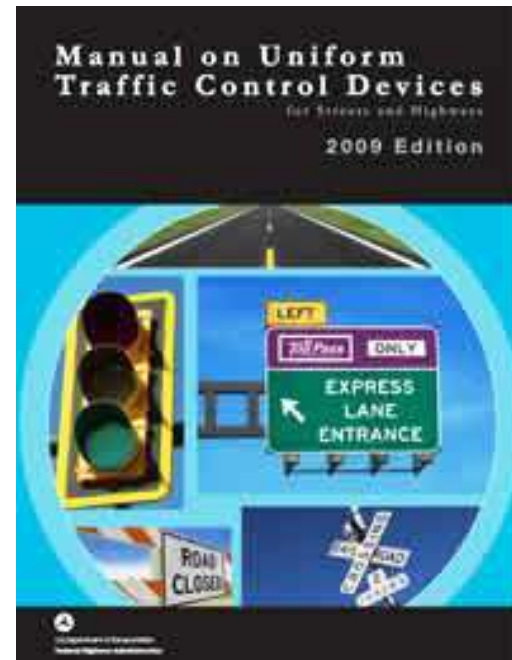

Chapter 7 Plaza Signs



P-IT2



P-IT3A



P-IT3B

I-Pass Pictograph



Chapter 7 Plaza Signs

Ramp Plaza Sign

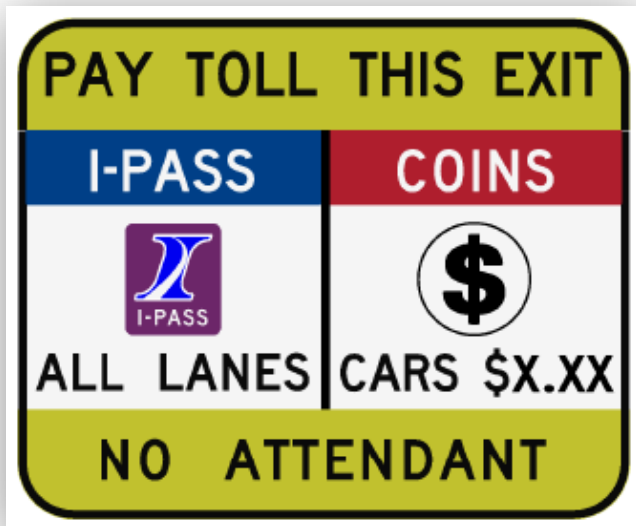

P-IT12B

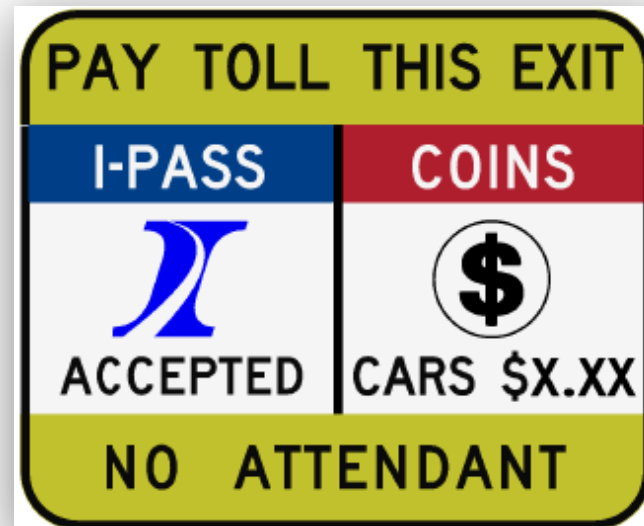

P-IT12C

Chapter 8 Electronic Toll Signs

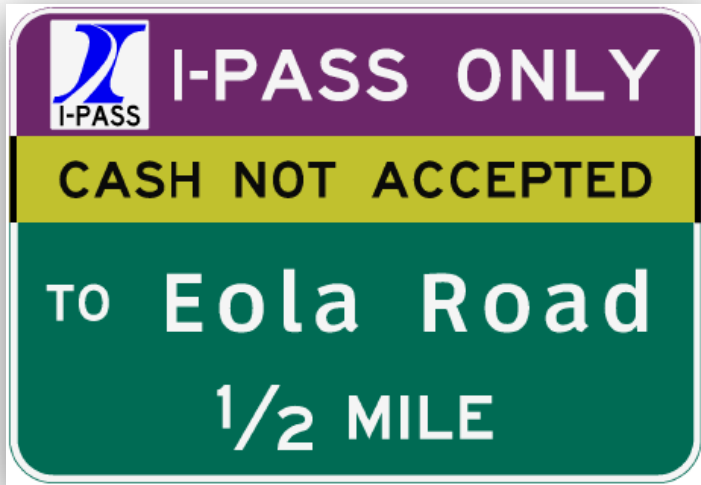

ET-IT4

ETC Advanced Exit



ET-IT6

ETC Advanced Toll

Chapter 9 Information Signs



Chapter 10 Dynamic Message Signs

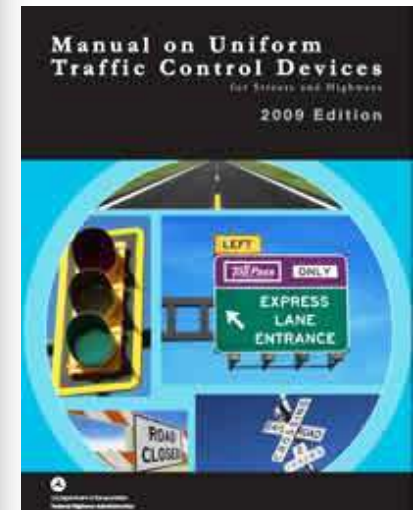

Chapter 11 Pavement Markings

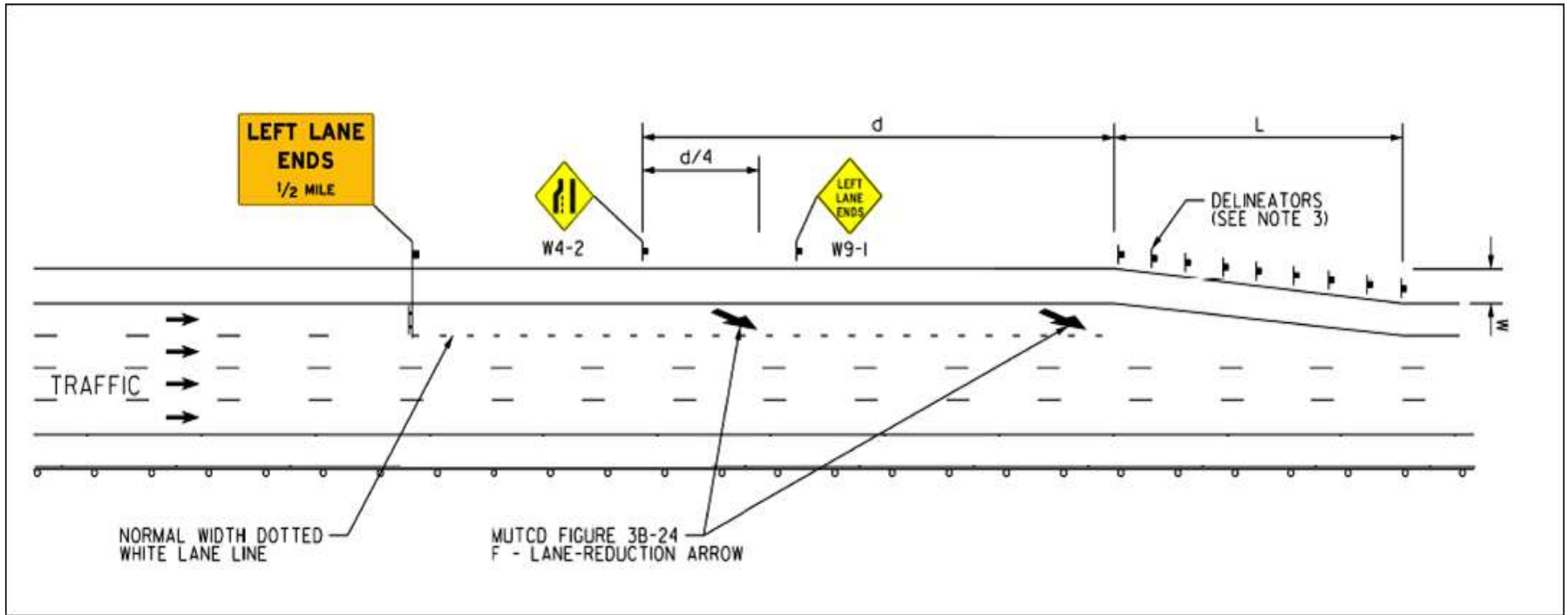

Lane Reduction Pavement Markings

Chapter 11 Pavement Markings

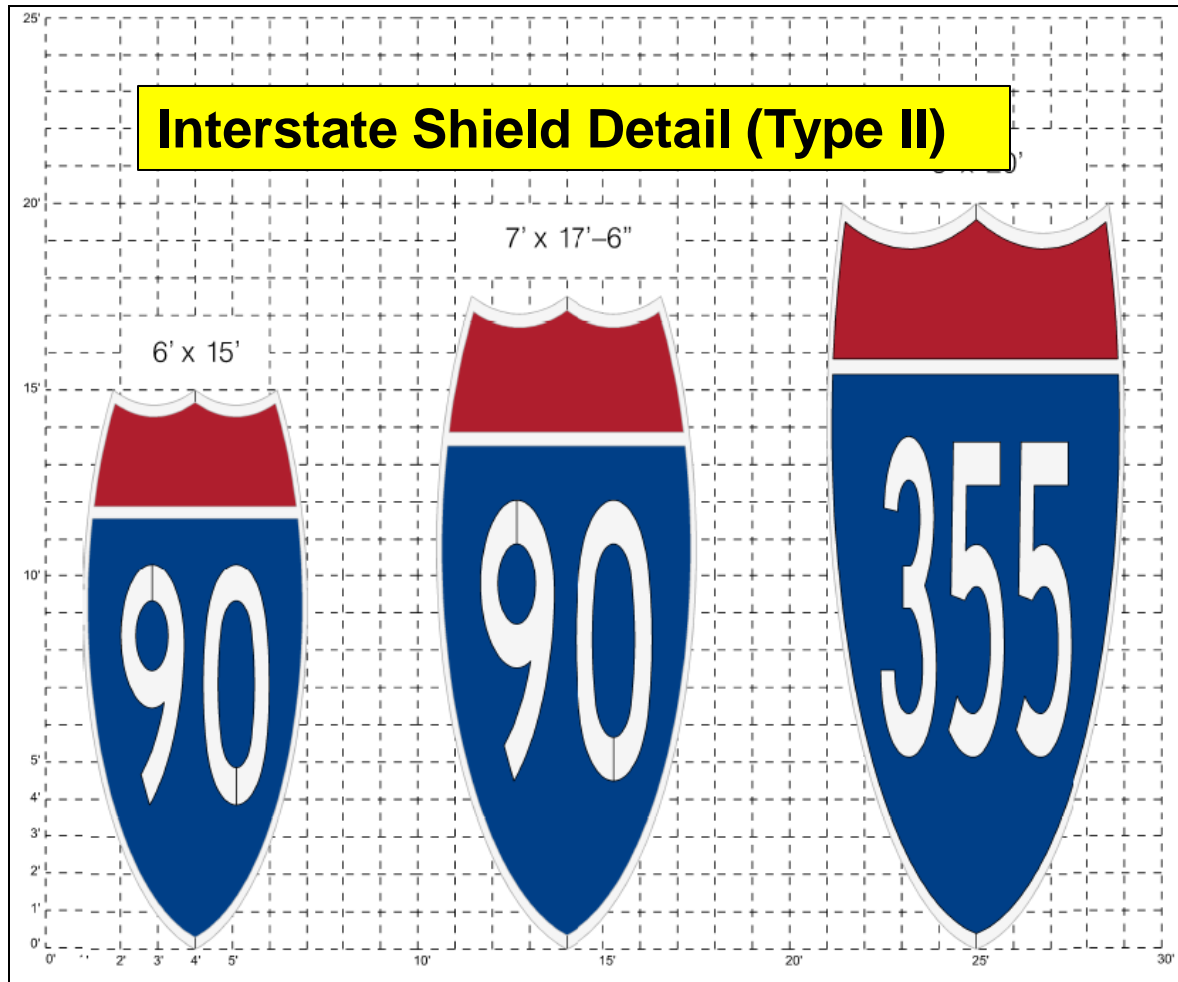

Chapter 13 Definitions, Acronyms, and Abbreviations

13 - Definitions, Acronyms and Abbreviations

13.1 - DEFINITIONS

This section contains definitions of frequently used terms as well as definitions with special or specific meanings as it applies to Tollway work. Whenever in this Manual the following proper nouns are used, their intent and meaning, both the singular and plural thereof, shall be as follows:

AASHTO. American Association of State Highway Transportation Officials.

AASHTO Roadside Design Guide. A guide that and maintained by the AASHTO Subcommittee on

Advisory Speed. A recommended speed for all conditions.

13.2 - ACRONYMS

The acronyms provided here are in addition to the abbreviations listed in the Definition of Terms:

AASHTO	American Association of State Highway and Transportation Officials
ANSI	American National Standards Institute
CMS	Changeable Message Sign
DSE	Design Section Engineer
ETC	Electronic Toll Collection

Questions ?



E-Mail: bmalinowski@getipass.com

