



ILLINOIS TOLLWAY NEWS

FOR IMMEDIATE RELEASE
December 13, 2022

LONG-TERM TRAFFIC SHIFTS BEGIN THIS WEEK ON THE CENTRAL TRI-STATE TOLLWAY (I-294) BETWEEN NORTH AVENUE AND WOLF ROAD

Two northbound lanes to shift onto the southbound side into counterflow configuration for winter

DOWNERS GROVE, IL – Beginning this week, a traffic shift is scheduled on the northbound Central Tri-State Tollway (I-294) between North Avenue and Wolf Road to prepare for winter and accommodate construction work as weather allows. Four lanes will remain open with two lanes traveling on the southbound side of the roadway in a counterflow configuration.

Traffic shifts are necessary to provide a safe work zone for median construction and accommodate traffic during construction. Electronic message signs and construction signage will be put in place in advance to alert drivers to the new traffic patterns. Up-to-date information regarding lane closures will be available in the Illinois Tollway's [Daily Construction Alert](#). All work is weather dependent.

Overnight Thursday, December 15, on northbound I-294 between North Avenue and Wolf Road, overnight lane closures will be scheduled starting at 7 p.m., with traffic reduced to a single lane at times, to complete the traffic shift. All lanes are scheduled to reopen by 5 a.m. on Friday, December 16 in advance of the morning commute, with two lanes of northbound traffic shifted to the right and two lanes traveling on the southbound side, creating a split traffic configuration with a work zone in the center. Southbound traffic is currently shifted to the outside to allow for the counterflow. Traffic is scheduled to remain in this configuration through fall of 2023.

If work cannot be completed during this time, backup closures will be scheduled during the week of December 19.

Traffic shifts and counterflow lanes will continue through 2024 as work continues to reconstruct and widen I-294, including rebuilding the bridges carrying I-294 over North Avenue, Grand Avenue and the Union Pacific Railroad and constructing the ramps that will connect I-294 to the new I-490 Tollway.

Construction in this area is being coordinated with the City of Elmhurst, Village of Franklin Park and City of Northlake, as well as local fire and police departments.

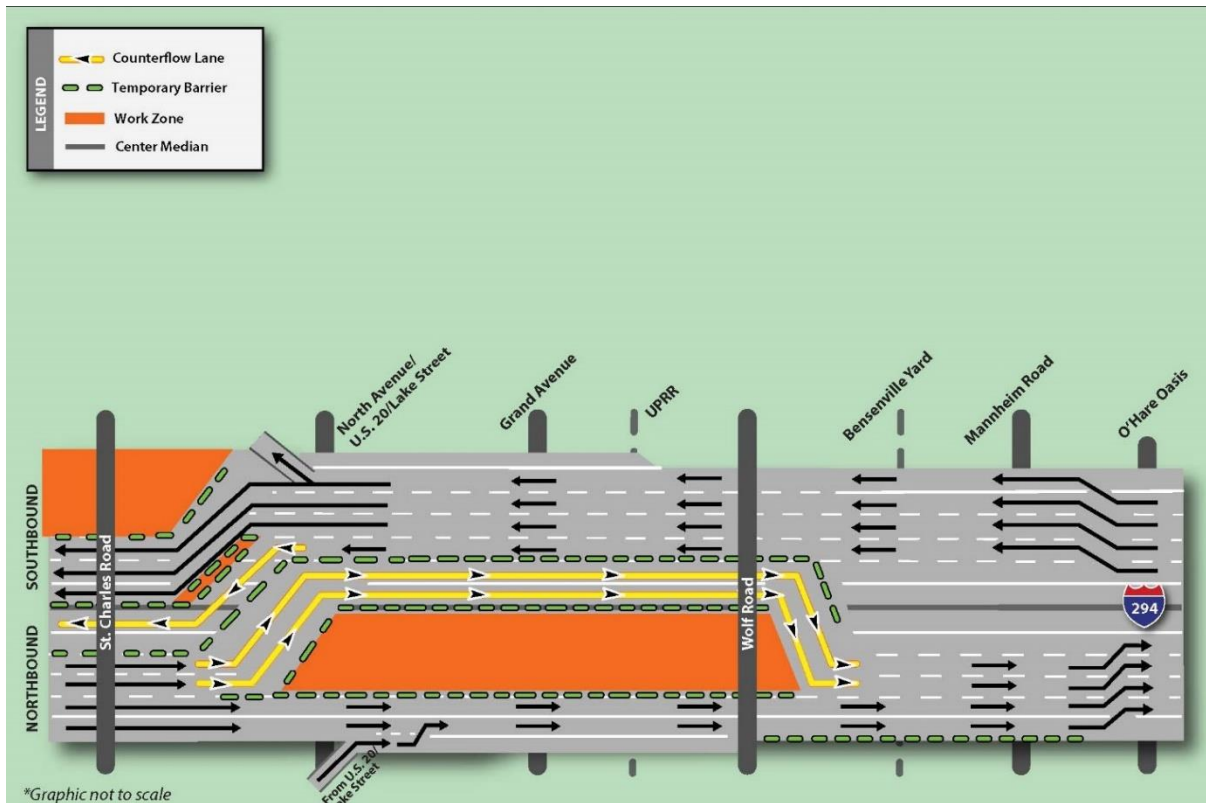

Construction updates, project information, maps and detour information for work that is part of the Central Tri-State Tollway (I-294) Project are available in the Projects section on the Tollway's website at www.illinoistollway.com.

Work in this section includes construction of the new I-490/I-294 Interchange with two new ramp bridges that will provide access for the new I-490 Tollway and a new southbound exit ramp from I-294 to County Line Road between Grand Avenue and North Avenue. Improvements as part of this project also include guardrail, drainage, lighting and signage installation, as well as landscaping improvements.

The \$4 billion Central Tri-State Tollway (I-294) Project is reconstructing and widening the roadway between Balmoral Avenue and 95th Street to provide congestion relief, update old infrastructure to meet current and future transportation demand and address regional needs. This work is part of the Tollway's 15-year, \$14 billion capital program, *Move Illinois: The Illinois Tollway Driving the Future*. More than 220,000 vehicles use the Central Tri-State Tollway daily.

Work Zone Safety

Construction zone speed limits are in effect in all construction zones 24/7 and drivers should continue to watch for changing traffic patterns and use caution, especially when workers are present. On I-294, a 45 mph work zone speed limit is in effect throughout the construction season.

The Illinois Tollway reminds motorists that the "Move Over Law" requires motorists to change lanes or to slow down and proceed with caution when passing any vehicle on the side of the road with hazard lights activated. If you see flashing lights ahead, please move over or slow down.

Illinois State Police have zero tolerance for drivers speeding in work zones or failure to comply with the Move Over Law. The minimum penalty for speeding in a work zone is \$250 with up to a \$25,000 fine and a 14-year jail sentence for hitting a roadway worker. Penalties for failure to slow down or move

over for a vehicle on the shoulder with flashing lights includes up to a \$10,000 fine, 2-year suspension of driving privileges and jail time, in extreme cases.

About *Move Illinois*

The Illinois Tollway's 15-year, \$14 billion capital program, *Move Illinois: The Illinois Tollway Driving the Future*, is improving mobility, relieving congestion, reducing pollution, creating as many as 152,000 jobs and linking economies throughout the region. The first 10 years of *Move Illinois* are on schedule and within budget, delivering the rebuilt and widened Jane Addams Memorial Tollway (I-90) as a state-of-the-art 21st century corridor and opening a new interchange connecting the Tri-State Tollway (I-294) to I-57. Progress continues on projects addressing the remaining needs of the existing Tollway system, delivering the Elgin O'Hare Western Access Project and planning for emerging projects, including reconstruction of the Central Tri-State Tollway (I-294).

About the Illinois Tollway

The Illinois Tollway is a user-fee system that receives no state or federal funds for maintenance and operations. The agency maintains and operates 294 miles of roadways in 12 counties in Northern Illinois, including the Reagan Memorial Tollway (I-88), the Veterans Memorial Tollway (I-355), the Jane Addams Memorial Tollway (I-90), the Tri-State Tollway (I-94/I-294/I-80) and the Illinois Route 390 Tollway.

###